

# ELECTRICAL SERVICES

FOR

26 ROSE CRES & 69-73 BOURKE ST, NORTH PARRAMATTA NSW 2151

DRAWING SCHEDULE

EL-DA-000 COVER SHEET  
EL-DA-100 SITE RETICULATION

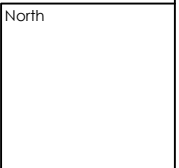

LOCKED BAG 5022  
PARRAMATTA NSW 2124  
PHONE No 1800 738 718  
<https://www.dpie.nsw.gov.au/land-and-housing-corporation>



**Barry Rush & Associates Pty Ltd**  
Architects, Nominated Architect: Barry John Rush  
ARB Registration No 3753  
Suite 25A, 2 Beattie Street, Balmain, NSW  
Phone: (02) 9555 8028 Email: [info@barryrush.com.au](mailto:info@barryrush.com.au)  
[www.barryrush.com.au](http://www.barryrush.com.au)

3	25.03.22	REVISED AS REQUESTED
2	24.03.22	REVISED DA ISSUE
1	02.02.22	DA ISSUE
REV	DATE	NOTATION/AMENDMENT
DO NOT SCALE DRAWINGS. CHECK ALL DIMENSIONS ON SITE. FIGURED DIMENSIONS TAKE PRECEDENCE.		

ARCHITECT <b>BARRY RUSH &amp; ASSOCIATES PTY LTD</b> PH (02) 9555 8028	PROJECT MANAGER <b>LAND &amp; HOUSING CORPORATION</b> PH (02) 8753 9000
LANDSCAPE CONSULTANT <b>GREENLAND DESIGN PTY LTD</b> PH 0403 164 106	

HYDRAULIC CONSULTANT <b>MARLINE NEWCASTLE PTY LTD</b> PH (02) 4925 9300 FAX (02) 4926 3811 MN1267.1	ELECTRICAL CONSULTANT <b>MARLINE NEWCASTLE PTY LTD</b> PH (02) 4925 9300 FAX (02) 4926 3811 MN1267.1
--------------------------------------------------------------------------------------------------------------	---------------------------------------------------------------------------------------------------------------



PROJECT:  
**SENIORS DEVELOPMENT  
26 ROSE CRES & 69-73 BOURKE ST  
NORTH PARRAMATTA, NSW 2151**  
Lots 2, 3 & 4 in DP 215342

TITLE: COVERSHEET		STATUS: DA ISSUE			
FILE: BGXWX-EL-DA-000.dwg	PLOTTED: 25/03/2022 4:00 PM	DATE: 01.02.22	SCALE: N.T.S	PROJ: C.T	PROJECT NO: BGXWX
		STAGE: -	DRAWN: L.R	CHECKED: C.T	NOMINATED ARCHITECT:
		TYPE: E	SHEET: EL-DA-000	REV: 3	



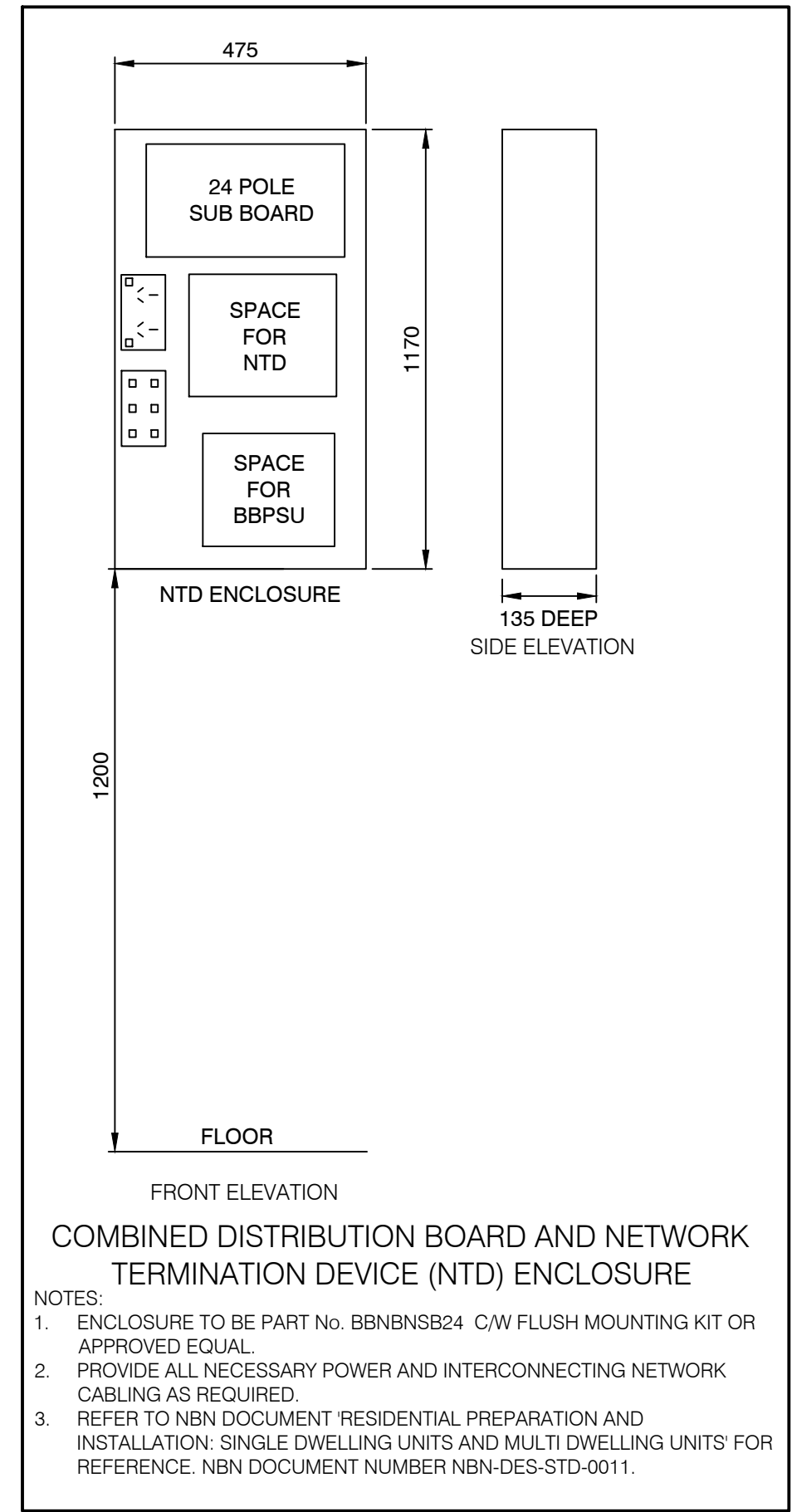
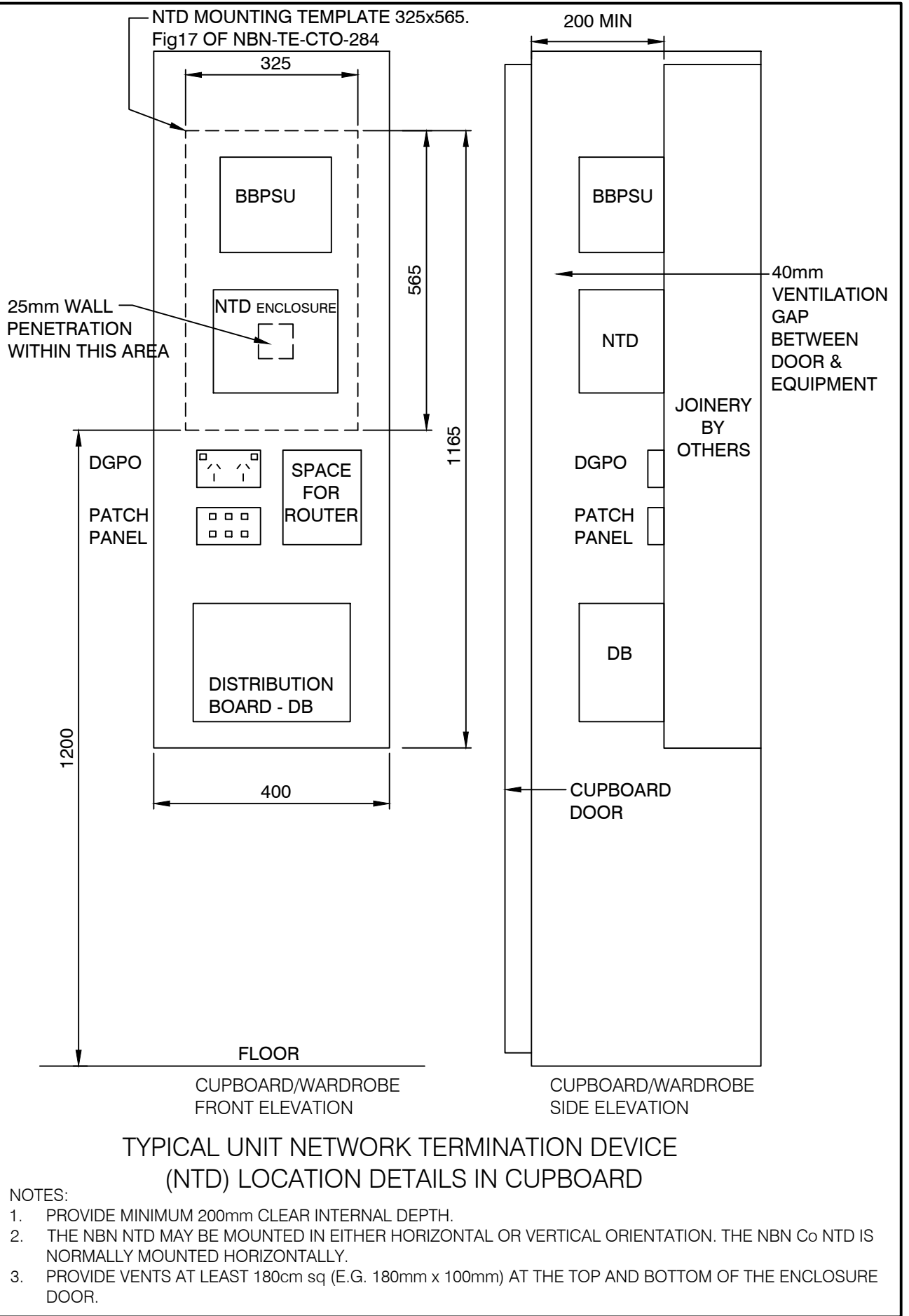
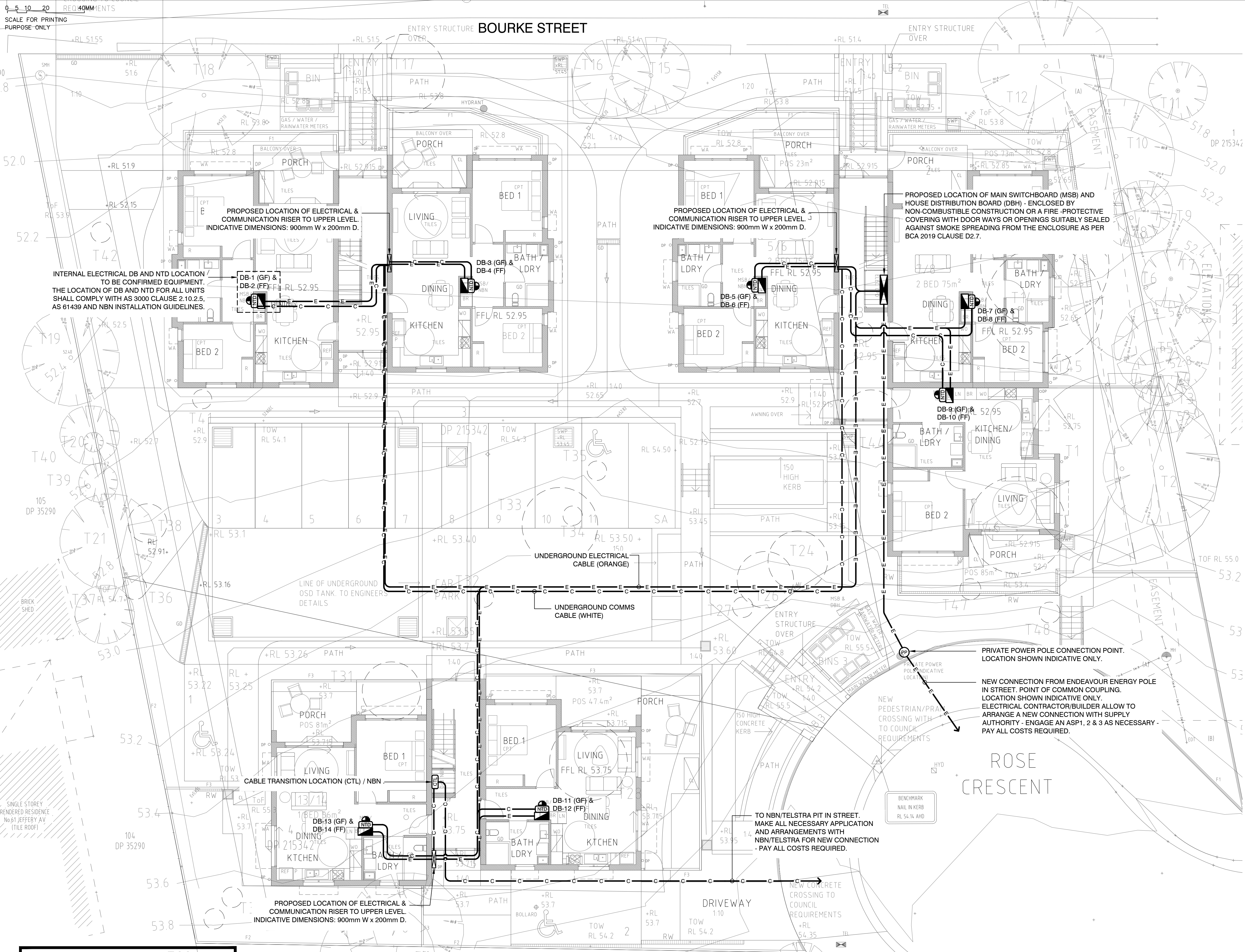

www.dialbeforeyoudig.com.au

**DIAL 1100**  
BEFORE YOU DIG

ATTENTION:  
ALL CABLING/CONDUITS TO BE CONCEALED IN  
WALLS/ UNDERGROUND. CO-ORDINATE/ SHARE  
TRENCH LOCATIONS WITH OTHER TRADES

LOCATIONS SHOWN ARE INDICATIVE ONLY -  
SEE ARCHITECTURALS & COORDINATE FINAL  
LOCATIONS WITH OTHER TRADES.

**Barry Rush & Associates Pty Ltd**  
Architects, Nominated Architect: Barry John Rush  
ARB Registration No 3753  
Suite 25A, 2 Beattie Street, Balmain, NSW  
Phone: (02) 9555 8028 Email: info@barryrush.com.au  
www.barryrush.com.au

3	25.03.22	REVISED AS REQUESTED
2	24.03.22	REVISED DA ISSUE
1	02.02.22	DA ISSUE
REV	DATE	NOTATION/AMENDMENT
DO NOT SCALE DRAWINGS. CHECK ALL DIMENSIONS ON SITE. FIGURED DIMENSIONS TAKE PRECEDENCE.		
ARCHITECT <b>BARRY RUSH &amp; ASSOCIATES</b> PTY LTD PH (02) 9555 8028		
PROJECT MANAGER <b>LAND &amp; HOUSING CORPORATION</b> PH (02) 8753 9000		
LANDSCAPE CONSULTANT <b>GREENLAND DESIGN</b> PTY LTD PH (040) 164 106		
HYDRAULIC CONSULTANT <b>MARLINE NEWCASTLE</b> PTY LTD PH (02) 4925 9300 FAX (02) 4928 3811		
ELECTRICAL CONSULTANT <b>MARLINE NEWCASTLE</b> PTY LTD PH (02) 4925 9300 FAX (02) 4928 3811		

**marline**  
BUILDING SERVICES ENGINEERS  
MECHANICAL . ELECTRICAL . HYDRAULIC . FIRE . ENERGY

PROJECT:  
**SENIORS DEVELOPMENT**  
**26 ROSE CRES & 69-73 BOURKE ST**  
**NORTH PARRAMATTA, NSW 2151**  
Lots 2, 3 & 4 in DP 215342

TITLE: <b>SITE RETICULATION</b>	STATUS: <b>DA ISSUE</b>	DATE: <b>01.02.22</b>	SCALE: <b>1:100</b>	PROJ: <b>BGXXW</b>	PROJECT NO: <b>BGXXW</b>
FILE: BGXXW-EL-DA-100.dwg	PLOTTED: 25/03/2022 4:00 PM	TYPE: <b>E</b>	SHEET: <b>EL-DA-100</b>	REV: <b>3</b>	